



Children growing up in disadvantaged communities face challenges every day.

You have inspired the giving of a gift that will make a real, lasting difference!

Gift: \_\_\_\_\_

To: \_\_\_\_\_

From: \_\_\_\_\_

Message: \_\_\_\_\_

\_\_\_\_\_

\_\_\_\_\_

\_\_\_\_\_

\_\_\_\_\_

\_\_\_\_\_

Every item in ChildFund's Real Gifts Catalog has been specifically requested by a real family and will make a real, life-changing difference. Thank you for bringing smiles to children in need. To learn more about the ChildFund's Real Gifts Catalog, visit [www.ChildFund.org/gifts](http://www.ChildFund.org/gifts) today.

ChildFund®

1-800-776-6767  
[www.ChildFund.org](http://www.ChildFund.org)

C221001CF

Job #	CFI_C221001CF	Job Description	Digital Assets	Component	Digital In Honor Of Card
Mail Date		Audience Info		Account Rep	Molly Heidbrick
FPD: LASER/VARIABLE/GUIDES DO NOT PRINT RGB		Size	8.5" x 11.0"	Stock	n/a
		Folds to Size	n/a	Ink Info	n/a
		Finishing		Other Info	

# INSTRUCTIONS

For best results, make sure your printer is set to print at 'Actual Size' on an 8.5" x 11" sheet of paper.

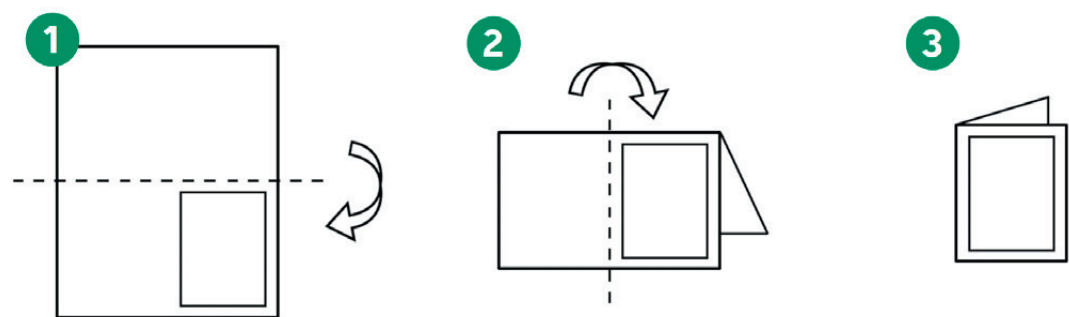

Job #	CFI_C221001CF	Job Description	Digital Assets	Component	Digital In Honor Of Card
Mail Date		Audience Info		Account Rep	Molly Heidbrick
FPD: LASER/VARIABLE/GUIDES DO NOT PRINT RGB		Size	8.5" x 11.0"	Stock	n/a
		Folds to Size	n/a	Ink Info	n/a
		Finishing		Other Info	